

Model: BLA-10A

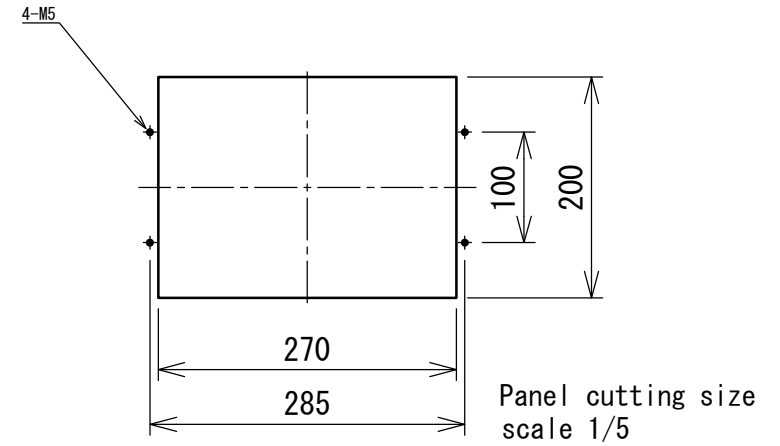

180° Opening and shutting lid

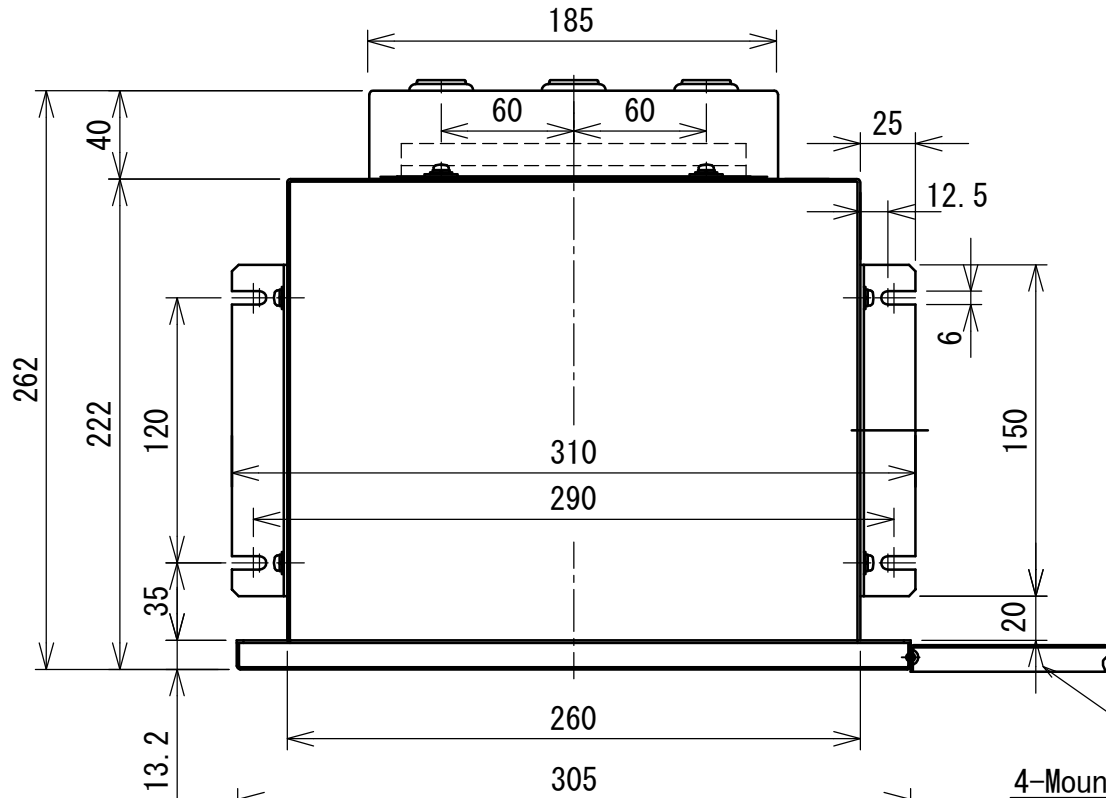
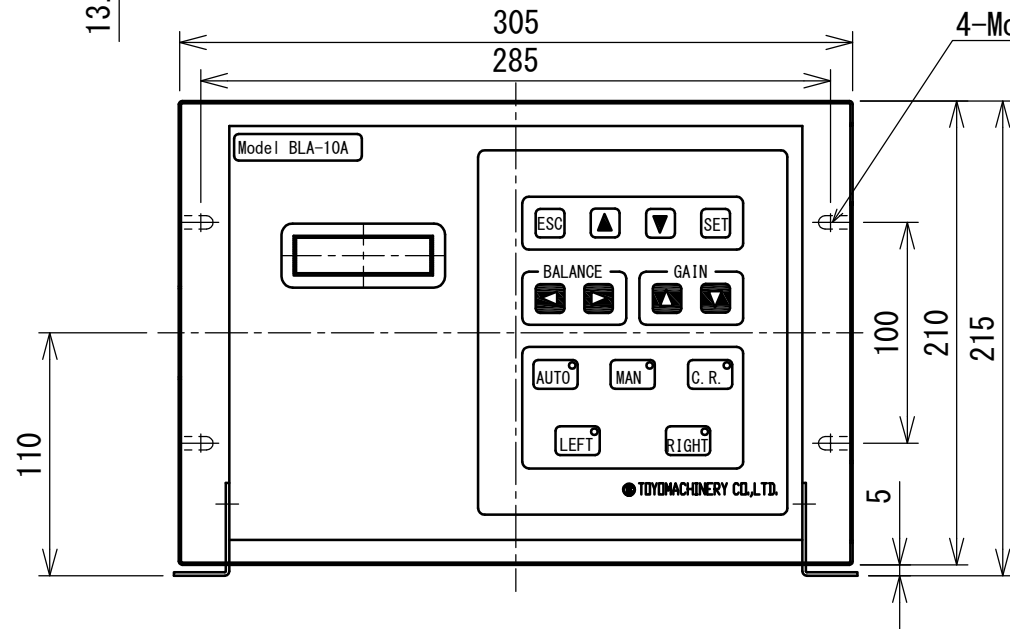

4-Mounting spots for panel cut

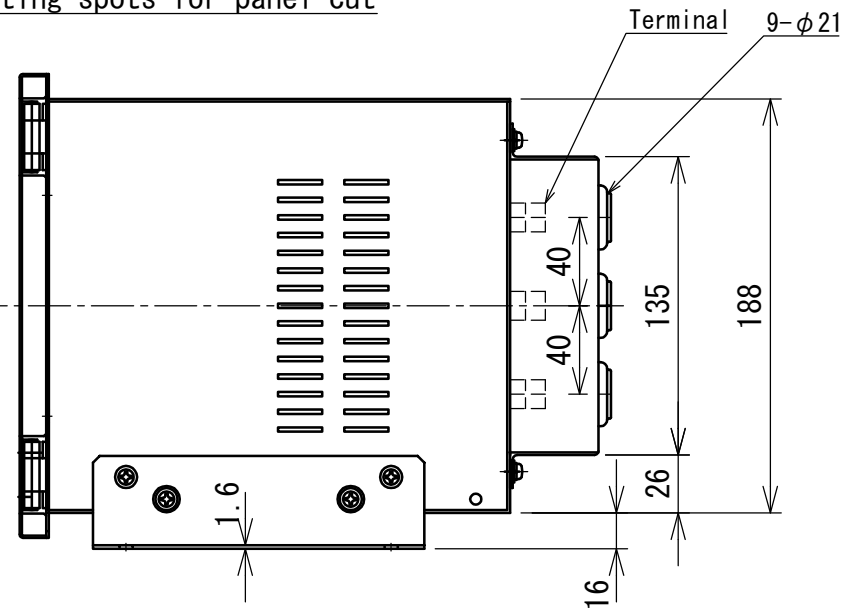

BLA-10A Specifications

Power supply	AC100 to 240V,50/60Hz,200VA Inrush current 90A,10msec,TYP(200V)
Ambient temperature	0 to 50°C
Ambient humidity	35% to 85%RH (non-condensing)
PHOTO-RELAY output	24VDC/AC, 50mA (max) On-State Resistance : 35Ω (max) Y0 to Y3
Analog output	0 to ±10VDC (10mA max) (Select the output signal.)
Analog input	0 to ±10VDC (max) (Edge sensor input) EA1-EB1,EA2-EB2
Digital input	Contact or open collector input Input impedance : Approx 4.7KΩ Ratings input current : Approx 5.1mA (At DC24V) Response time : Approx 0.1sec X0 to X7, CL, CR, LA1, LB1
Offset input	Potentiometer (5KΩ) VR1, VR2, VR3
Positional sensor input	Potentiometer (5KΩ) P1, P2, P3
Data communication	RS-485 Baud rate (4800/9600/14400/19200bps)
Applicable sensor	BLD-10, BLD-S10, ESD-20, 30, 40 Various edge sensors (ON/OFF sensor is excluded.)
Application drive unit	WB-70A, WB-80, EC-70
Fuse	250V/5A
IP grade	IP30
Power-supply noise	2.5kVp-p, Common mode 50ns, 1us width
Painting	Munsell N4.0
Mass	Approx. 6kg

Model: BLA-11A

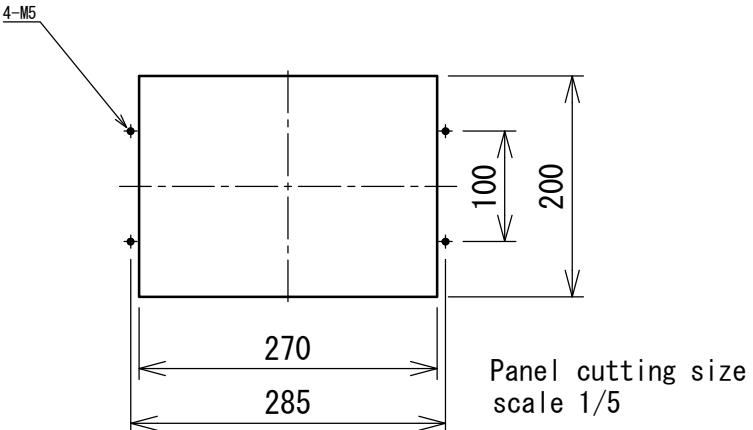
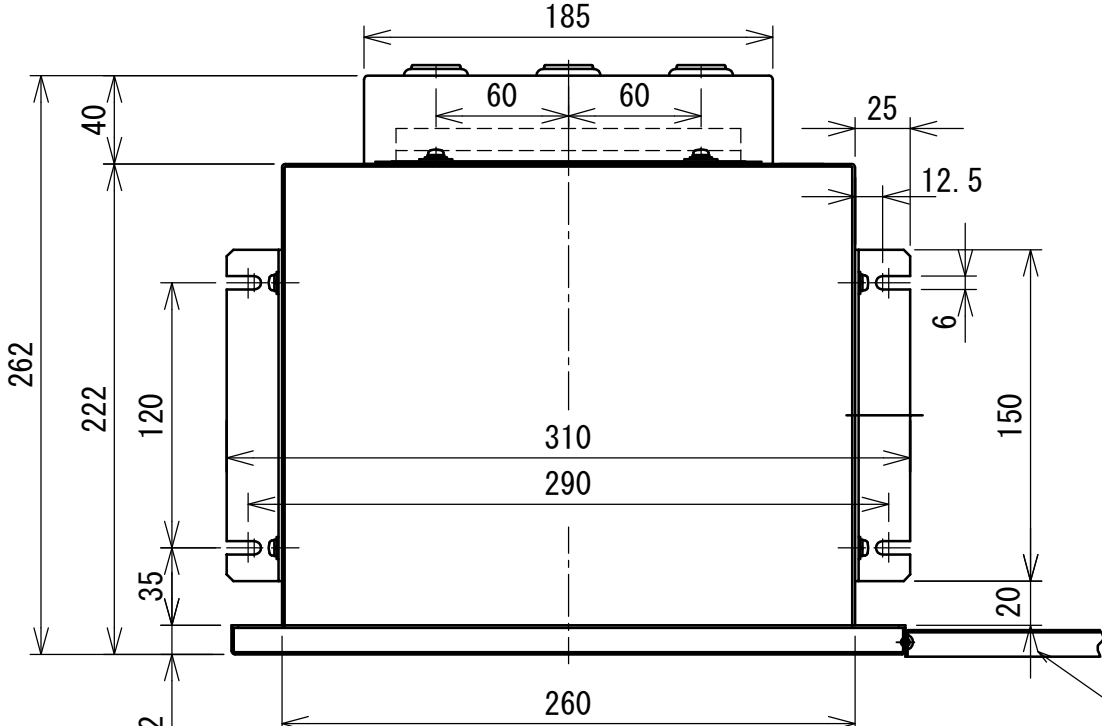

180° Opening and shutting lid

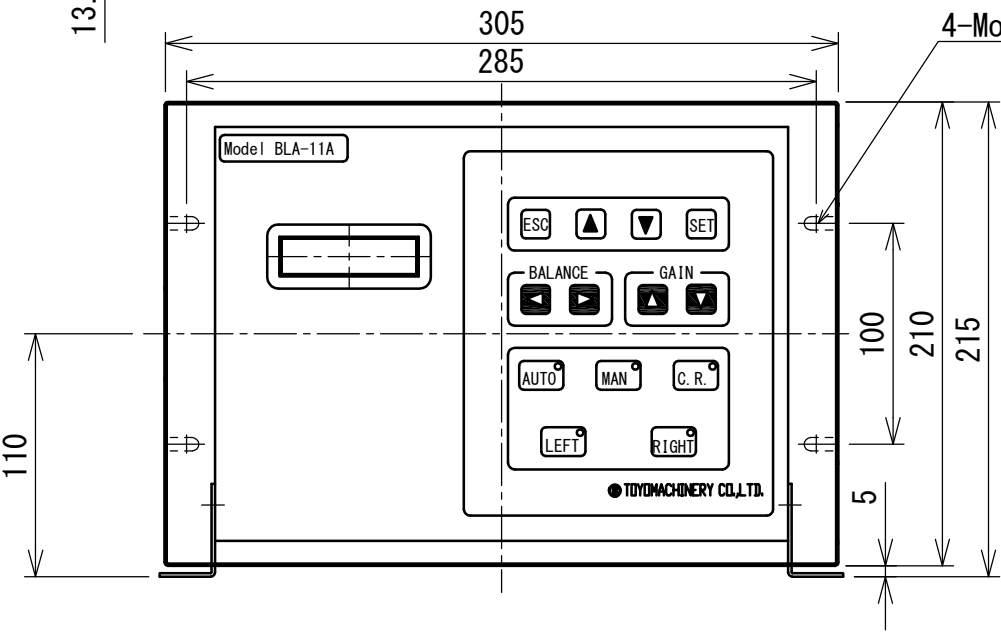

4-Mounting spots for panel cut

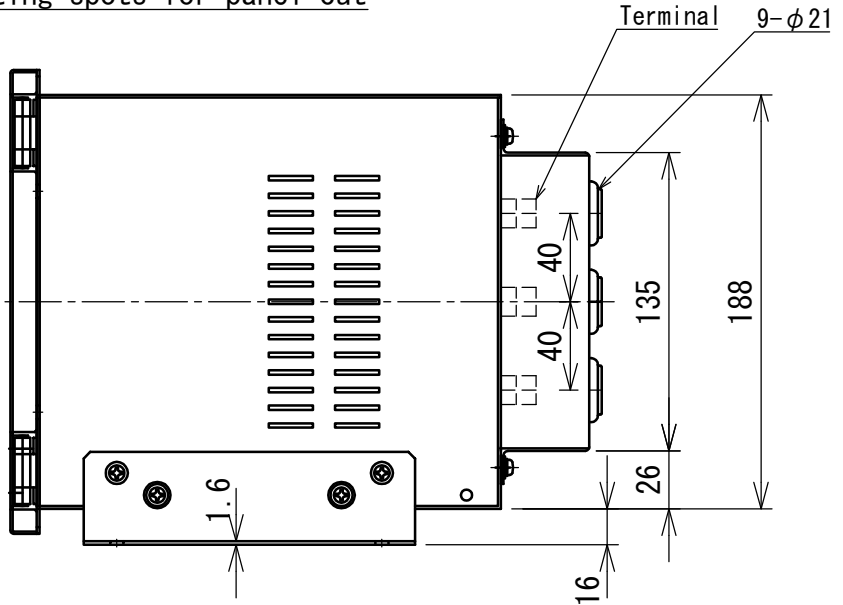

BLA-11A Specifications

Power supply	AC100 to 240V,50/60Hz,200VA Inrush current 90A,10msec,TYP(200V)
Ambient temperature	0 to 50°C
Ambient humidity	35% to 85%RH (non-condensing)
PHOTO-RELAY output	24VDC/AC, 50mA (max) On-State Resistance : 35Ω (max) Y0 to Y3
Analog output	0 to ±10VDC (10mA max) (Select the output signal.)
Analog input	0 to ±10VDC (max) (Edge sensor input) EA1-EB1,EA2-EB2
Digital input	Contact or open collector input Input impedance : Approx 4.7KΩ Ratings input current : Approx 5.1mA (At DC24V) Response time : Approx 0.1sec X0 to X7, CL, CR, LA1, LB1
Offset input	Potentiometer (5KΩ) VR1, VR2, VR3
Positional sensor input	Potentiometer (5KΩ) P1, P2, P3
Data communication	RS-485 Baud rate (4800/9600/14400/19200bps)
Applicable sensor	BLD-10, BLD-S10, ESD-20, 30, 40 Various edge sensors (ON/OFF sensor is excluded.)
Application drive unit	EC-75, 20W, 40W (DC motor)
Fuse	250V/5A
IP grade	IP30
Power-supply noise	2.5kVp-p, Common mode 50ns, 1us width
Painting	Munsell N4.0
Mass	Approx. 6kg